

PORTEX BAG/USEFUL INFORMATION

PORTEX DRAINAGE INFORMATION SHEET DIRECTIONS FOR USE AND HELPFUL TIPS

Fig 1 Basic diagram of a portex drainage system

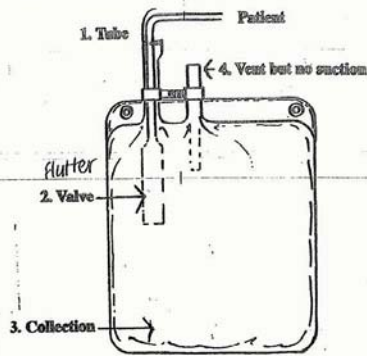

1. Before attaching the bag to the patient, the flutter valve must be primed. Using a 20 ml syringe inject air slowly through the drainage tube. You should see the valve move slightly.

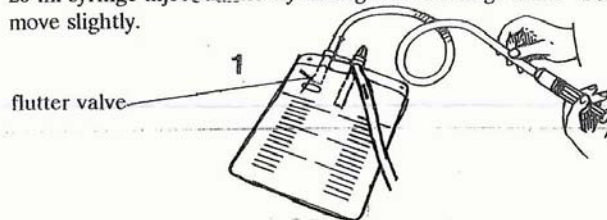

2. Clamp the patients drain and connect the bag to the patient, ensuring that the connection is made. Unclamp and visually confirm the flutter valve is functioning it should be moving (see fig 1)

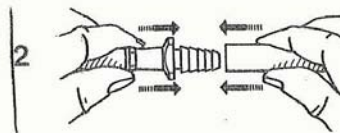

3. Adjust the shoulder strap to fit the patient and ensure that the bag is kept upright.

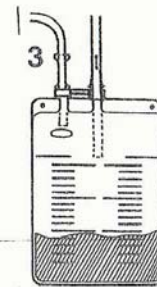

4. To empty the bag, turn upside down and allow the contents to drain through the white air vent on the top of the bag. Clean the valve once emptied to ensure that it is not blocked